

MANUAL

DESCRIPTION

Barrina LED T5 fixture provide high performance, long life and energy savings in a simple, no-frills conventional looking fixture.



Energy Efficient
Cost Savings in Monthly Bills



High Luminous Efficacy
More lumen for your watt



Runs on Direct Power Supply
Instant On & Flicker Free



Quality & Durability
Long Lifespan

INSTALLATION DRAWING



Disconnect power before installation.

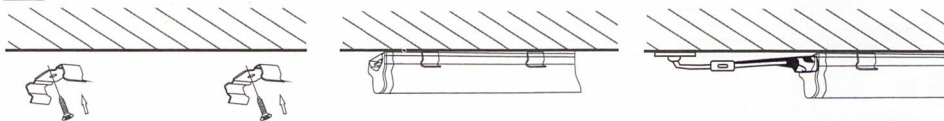

When connecting 2FT LED T5 fixture in a series, please do not connect more then 12 lights.
When connecting 3FT LED T5 fixture in a series, please do not connect more then 10 lights.
When connecting 4FT LED T5 fixture in a series, please do not connect more then 8 lights.

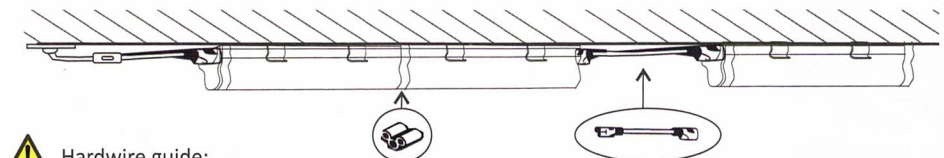

Hardwire guide:

Live wire(L) = Black wire = Brown wire; Null wire(N) = White wire = Blue wire;
Earth wire(E)= Yellow/Green wire;

WARNING

1. Please read specification first to make sure service environment matches the conditions in the specifications
2. Product is for indoor use only.
3. Unauthorized personnel is not allowed to disassemble the product.
4. Damaged external cables should be replaced by manufacturer, service agent or by trained professional.
5. Product should not be subjected to mechanical stress.
6. Keep away from direct sunlight or high-temperature.
7. If there any damage on the power line or the shell of the product, it should be taken as defective and must not be used.

WARRANTY

3-YEAR WARRANTY

These lights have 3-year warranty. If you have any problem during using our products, please feel free to contact seller, and a member of our support team will be in touch within 24 hours to provide a resolution to the issue.